

## BIRCH TREE COURT LEVEL 7

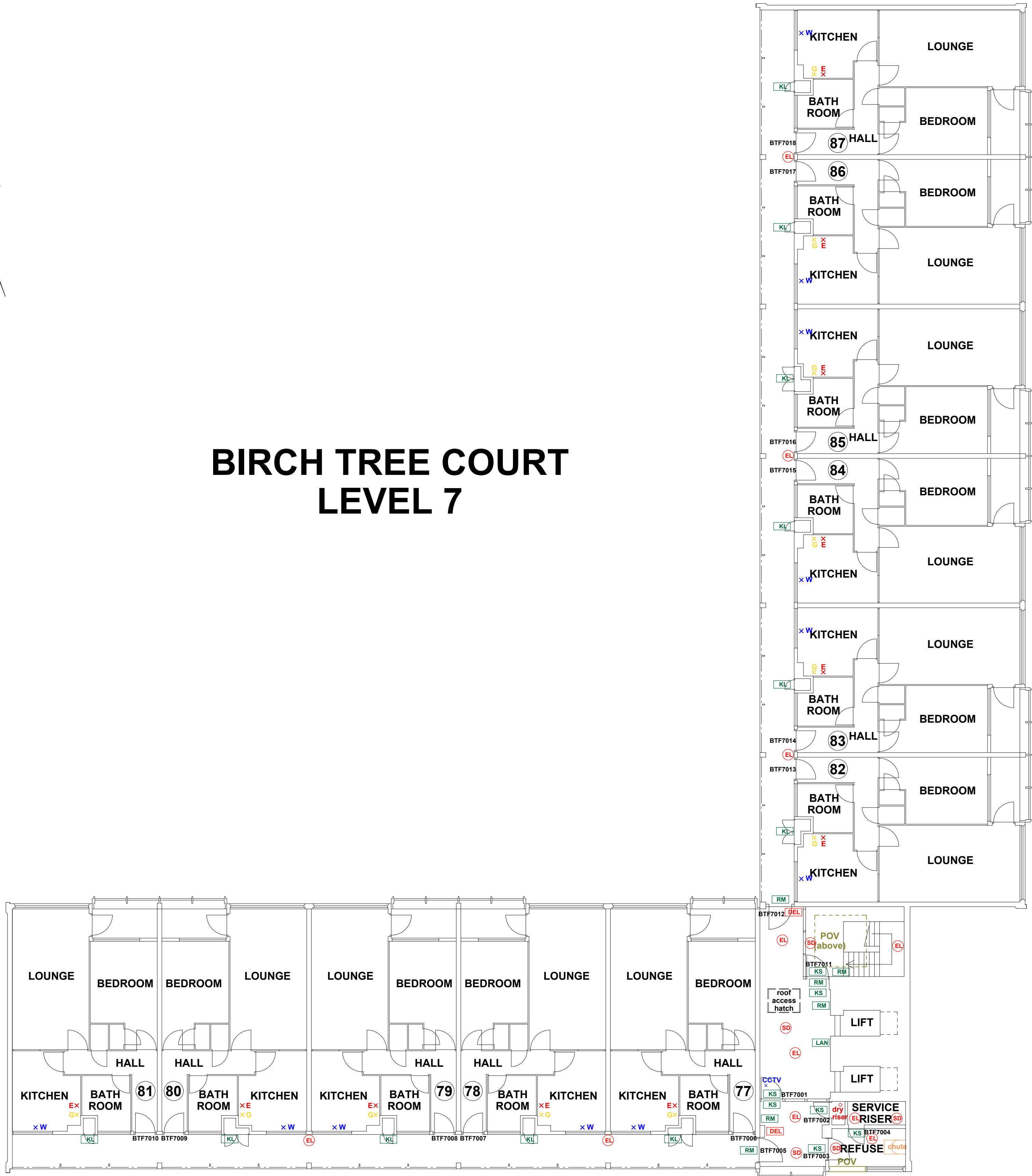

### FIRE PRECAUTIONS LEGEND

- EL** Break glass type fire alarm call point
- HB** Heat sensitive detectors
- SD** Smoke sensitive detectors
- EL** Emergency light point.
- FS** Firemans Switch
- DKA** Emergency Drop Key Access
- FAP** Fire alarm indicator / repeat panel
- GD1** Door/Access fitted with Gerda D1 Key lock
- FB1** Door/Access fitted with FB1 Key lock
- FB2** Door/Access fitted with FB2 Key lock
- FB4** Door/Access fitted with FB4 Key lock
- FB11P** Door/Access fitted with FB11 Padlock
- FB14P** Door/Access fitted with FB14 Padlock
- DRO** Dry Riser Outlet
- DEL** Digital electronic lock door entry/exit system
- PIB** Premises Information Box
- POV** Permanently Open Vent
- AOV** Automatic Opening Vent
- OV** Openable Vent
- EL** Fire alarm sounder ('X' indicates integral flashing - Xenon light)
- CCTV** CCTV Security Camera
- FB** Fire Brigade Key Access
- EXTINGUISH**
- BLNRT** 1.1m x 1.1m fire blanket - base of container to be 1500mm above floor level
- A** 6 litres AFFF aqueous foam extinguisher to BS:6575
- P** 9 litre wet chemical type extinguisher
- D** 4.5 litre dry powder type extinguisher
- C** 2 kg carbon dioxide type extinguisher
- K** 4.5 kg carbon dioxide type extinguisher
- W** 9 kg water type extinguisher
- W** 6 litre water type extinguisher
- FIRE EXIT SIGNAGE**
- E** 'E' Signs to be externally illuminated by adjacent emergency light point
- FE** 'FE' denotes as previous but illuminated as part of sign
- RM** 'RM' denotes non illuminated sign
- FIRE DOOR SIGNS AND FIRE ACTION NOTICES**
- FAN** Fire Action Notice
- EFPP** Emergency Floor Plan
- KS** "FIRE DOOR KEEP SHUT" sign
- KL** "FIRE DOOR KEEP LOCKED" sign
- KC** "AUTOMATIC FIRE DOOR KEEP CLEAR" or "FIRE EXIT KEEP CLEAR" sign
- LAN** "CAUTION, IN THE EVENT OF FIRE DO NOT USE THIS LIFT"
- DB** DISTRIBUTION BOARD

0 5 10  
SCALE (METRES)

REV DATE AMENDMENTS



WEB: WWW.FIRNTEC.COM  
EMAIL: CONTACTUS@FIRNTEC.COM  
ADDRESS: 1ST FLOOR, ENDEAVOUR HOUSE,  
PARKWAY CT, PLYMOUTH PL6 8LR  
TEL: 01752 877 147

PROJECT: BIRCH TREE COURT

ADDRESS: BIRCH TREE COURT  
WYTHENSHAW  
MANCHESTER  
M22 3RY

DWG NO.: BTC\_220020L08

DWG TITLE: LEVEL 7

DWG DATE: NOVEMBER 2022

DWG SIZE: SCALE 1:100 @ A1

DRAWN: NR

CHECKED: BR

ISSUE